

Atlona Captive Screw Ready IR Receiver

AT-IRX-CS



Introduction

The Atlona Captive Screw Ready IR Receiver provides greater distance and better IR rejection from sources such as: plasma, CFL, and LCD panels.

Features and Specifications

- Frequency range from 30 to 60 kHz
- Distance up to 10m w/no interference on axis
 - *Operational distance may vary due to interference from IR radiating sources
Ex. Sunlight, CFL, LCD, or Plasma displays
- Reception Angle: +/- 45° off axis
- Dimensions (H x W x D)

10 x 62 x 10 (mm)
0.39 x 2.44 x 0.39 (inch)
- Red status LED indicator for quick verification the IR receiver is picking up the IR remote's signal

Captive Screw

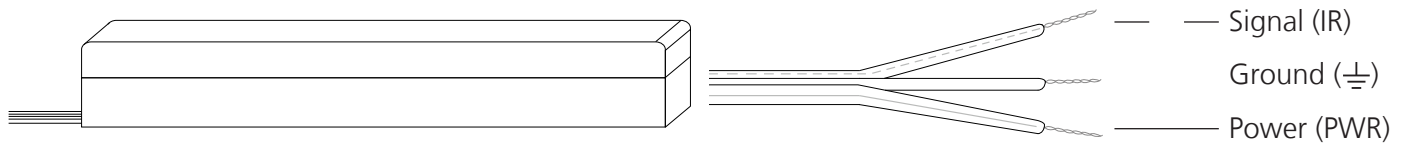

Connection Diagram

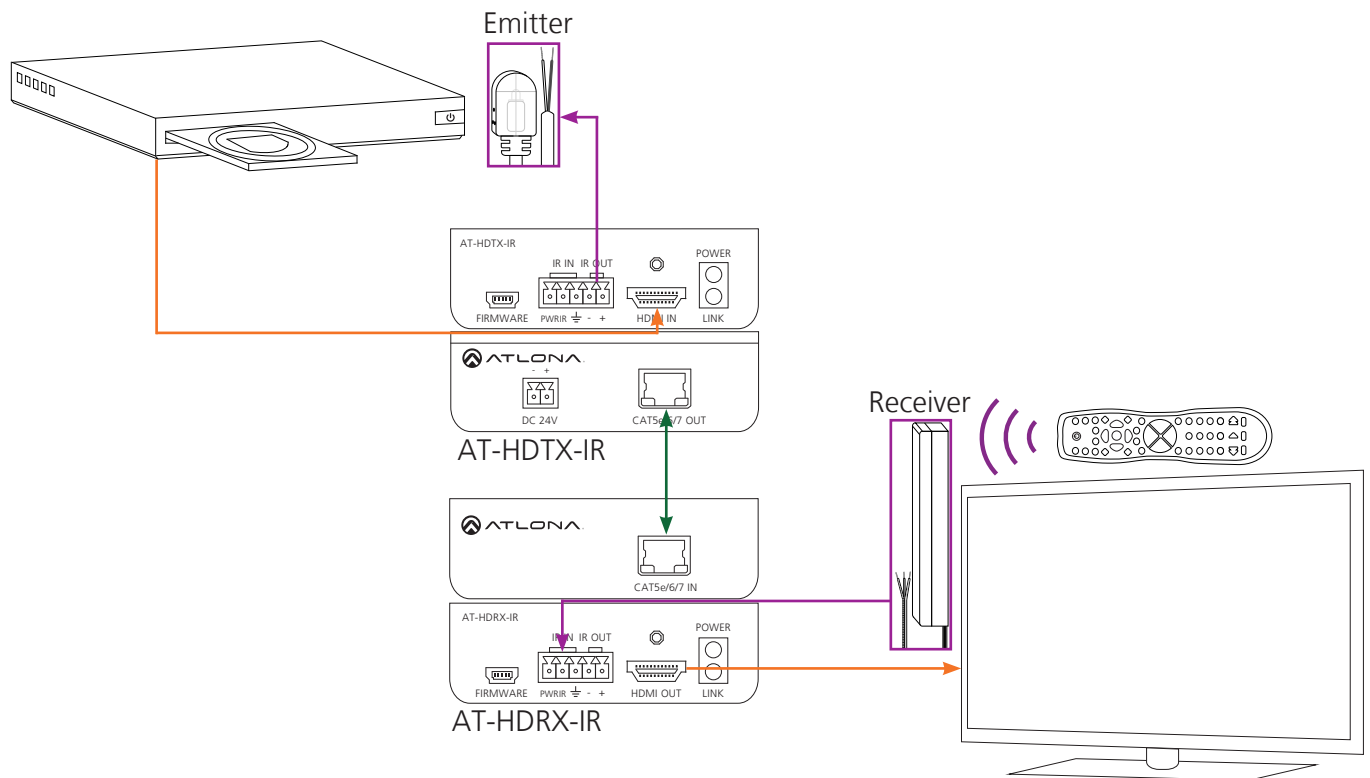

* Designed for select Atlona products

** For warranty information see http://www.atlona.com/marketing/img/limited_warranty/